

2014/07/25

Ford F150 hydride MyTouch installation Customtronix 2014

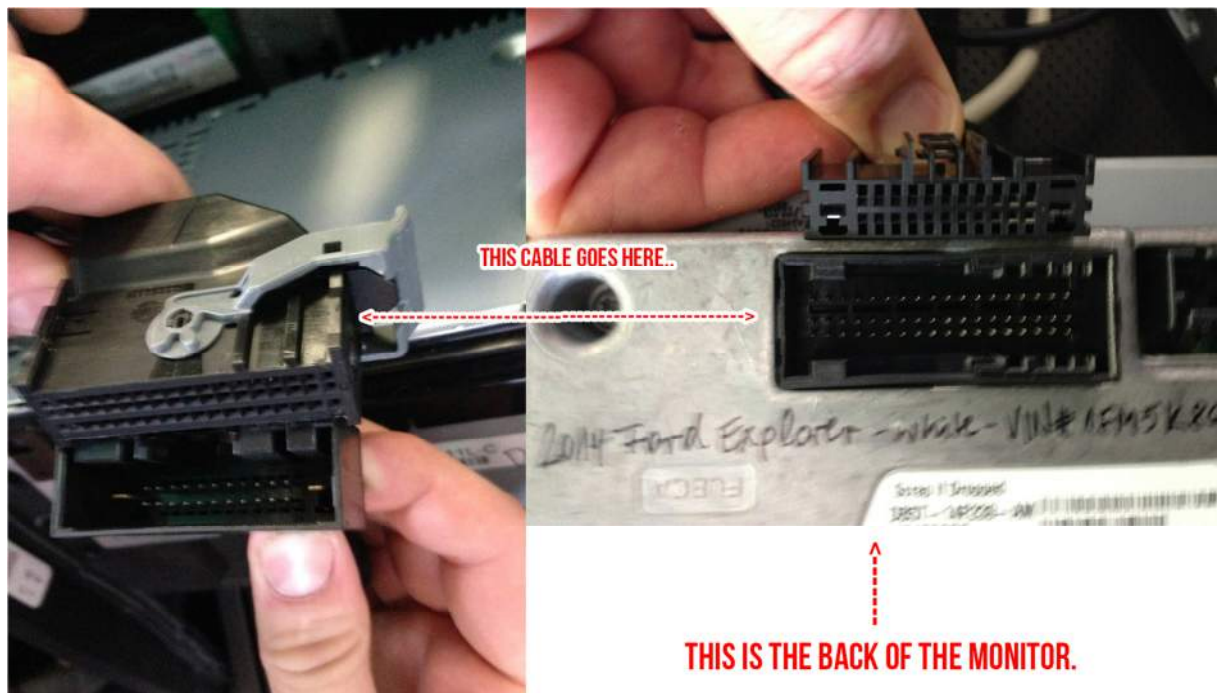

Chapter 1 - Install

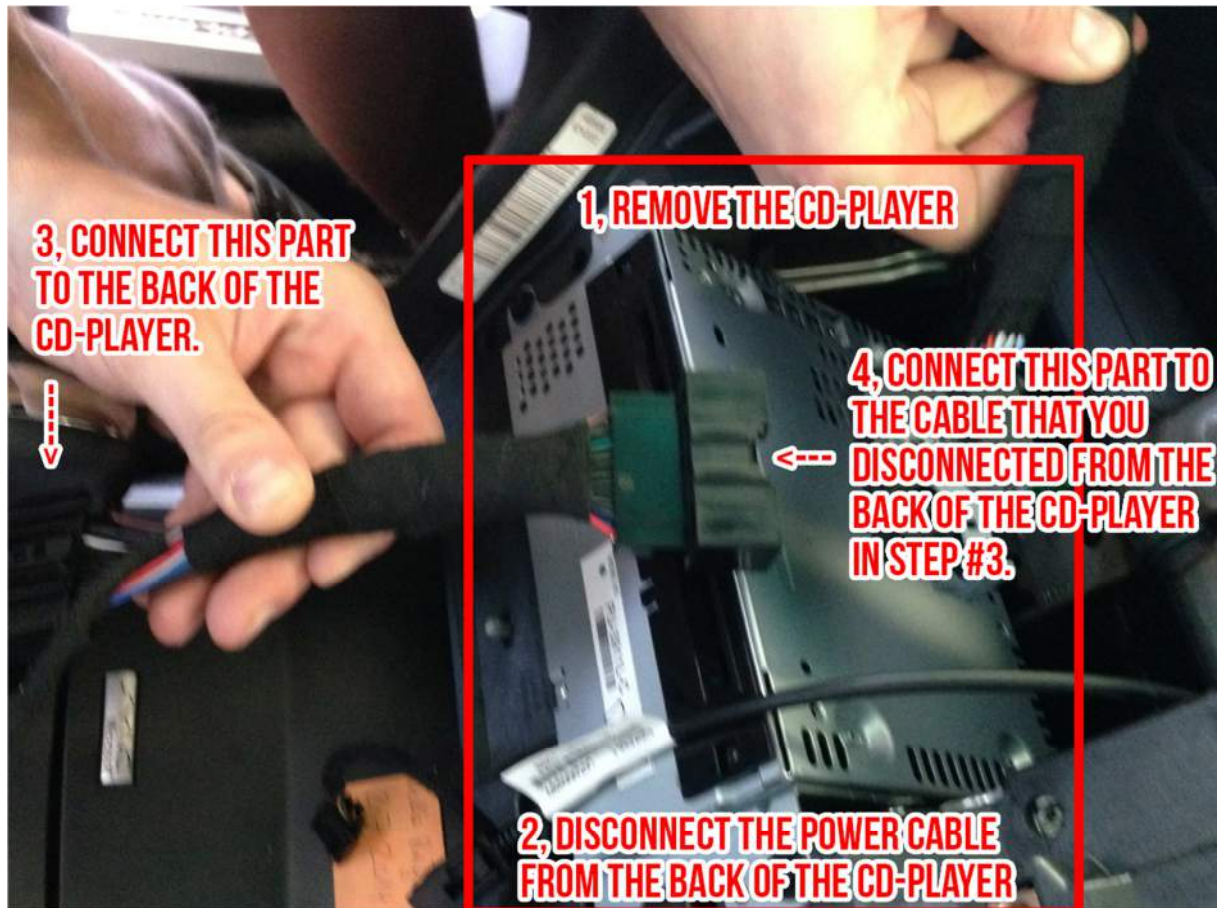

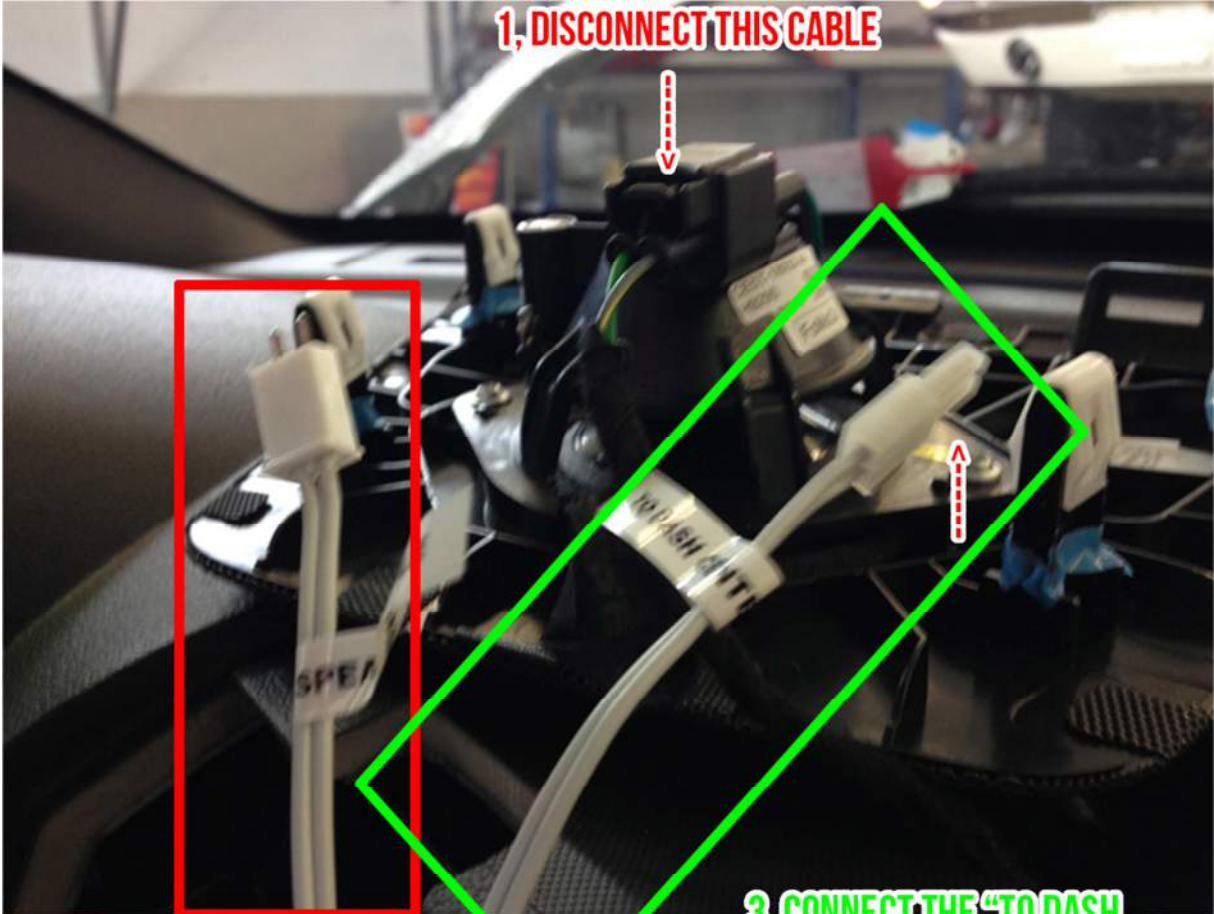

1, DISCONNECT THIS CABLE



**2, CONNECT THE CABLE
"TO DASH CENTER
SPEAKER CABLE"
HERE.**

**3, CONNECT THE "TO DASH
CENTER SPEAKER" CABLE INTO
THE SPEAKER.**

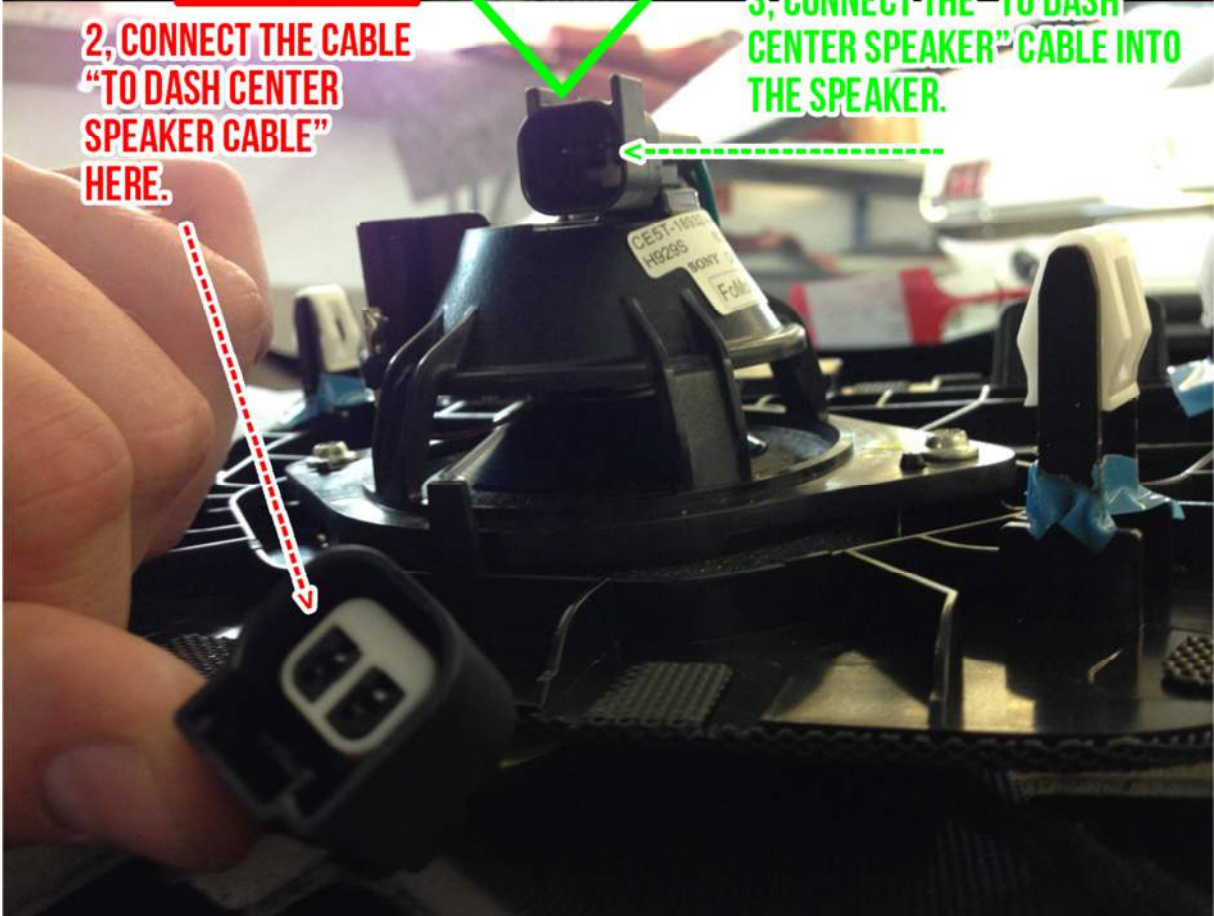

**3, CONNECT THE "TO DASH
CENTER SPEAKER" CABLE INTO
THE SPEAKER.**